

LADY OF THE GRAVE™

Installation and Operating Instructions

Keep all plastic and wire parts away from children.

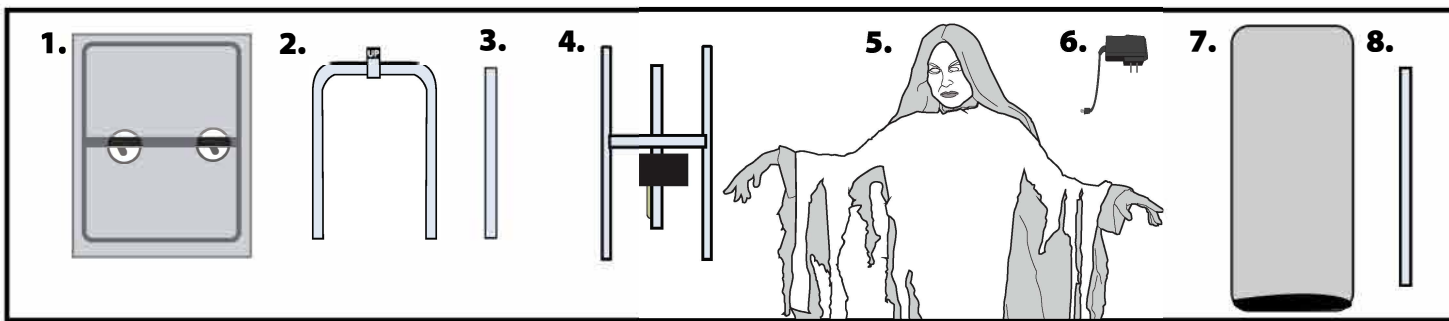

PARTS

1. METAL BASE
2. UPPER FRAME
3. UPPER FRAME POLE
4. LOWER FRAME AND MODULE
5. BODY
6. ADAPTER
7. FABRIC FRAME COVER
8. CENTER BODY POLE

1. Snap lock LOWER FRAME AND MODULE onto METAL BASE. (Match A to A) and (Match B to B)
2. Snap lock UPPER FRAME AND CENTER POLE onto LOWER FRAME AND MODULE. (Match C to C) and (Match D to D)
3. Slide the UPPER FRAME POLE through the sleeve marked **UP** on the UPPER FRAME. Snap lock the UPPER FRAME POLE into the LOWER FRAME AND MODULE. (Match E to E)
4. Attach the spring located on the LOWER FRAME AND MODULE to the hook on the UPPER FRAME AND CENTER POLE. (Match YELLOW TO YELLOW)
5. Attach the spring located on the UPPER FRAME AND CENTER POLE to the hook on the CENTER POLE. (Match BLUE TO BLUE)
6. Slide the FABRIC FRAME COVER over the assembled UPPER FRAME AND CENTER POLE.
7. Snap lock the CENTER BODY POLE onto the UPPER FRAME POLE. (Match F to F)
8. Snap lock the BODY onto the CENTER BODY POLE. (Match G to G)
9. Reach inside the FABRIC FRAME COVER and connect the wire labeled H from the CONTROL BOX to the wire running from the BODY outside the FABRIC FRAME COVER. (Connect H to H)
10. Connect the two wires labeled I **LOCATED UNDER THE FABRIC**. (Connect I to I)
11. Reach inside the FABRIC FRAME COVER and connect 6V 2A ADAPTER (included) or insert 4 AA alkaline batteries (not included) into the battery compartment located on the MODULE. Turn the switch to the ON position to activate the item. Make a loud sound (clap) to activate. Turn the item OFF when not in use.
12. Attach the four hook and loop fasteners on the FABRIC FRAME COVER to the hook and loop fasteners on the METAL BASE.
13. Position the arms and dress as seen in illustration.

NOTE: SPRING MUST BE ATTACHED ONLY TO THE CORRECT COLOR CODE OR IT WILL DAMAGE THE SPRING!

NOTE: SPRING MUST BE ATTACHED ONLY TO THE CORRECT COLOR CODE OR IT WILL DAMAGE THE SPRING!

NOTE: FOR USE IN WIND - PLACE WEIGHT ON METAL BASE FOR EXTRA STABILITY AS NEEDED.

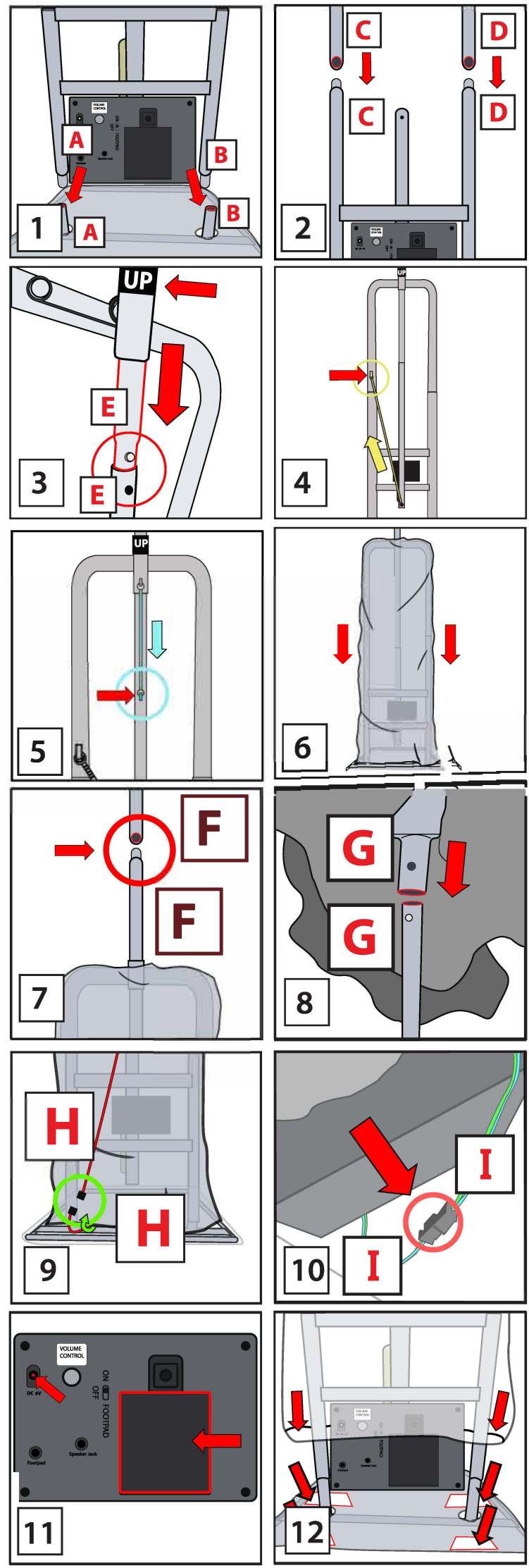

OPTIONAL FOOTPAD SET UP

FOOTPAD IS NOT INCLUDED. MUST BE PURCHASED SEPARATELY.

1. Insert the cable from optional footpad into the jack labeled FOOTPAD on the MODULE.
2. Place the switch in the FOOTPAD position to enable FOOTPAD activation.
3. Step on the FOOTPAD to activate the scary sequence!

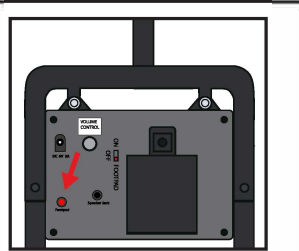

OPTIONAL EXTERNAL SPEAKER SET UP

EXTERNAL SPEAKER IS NOT INCLUDED. MUST BE PURCHASED SEPARATELY.

1. Plug speaker cord into the jack labeled SPEAKER JACK located on the MODULE.
2. Use volume knob on external speaker to control volume levels.

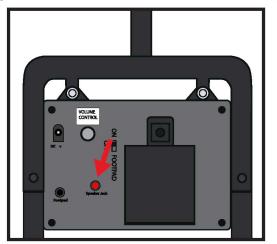

* Footpads and adapters are sold separately and can be purchased at www.tekkyaccessories.com

SMART PHONE SCAN SETUP VIDEO



BATTERY INSTRUCTIONS AND CAUTIONS
 Battery installation and removal should be performed by an adult. Remove batteries when not in use. Use only batteries recommended in the instructions. Do not mix new and used batteries. Do not mix alkaline, carbon-zinc, nickel-cadmium, rechargeable or different types of batteries. Be mindful to insert batteries with the correct polarity (+/-) as indicated. Remove all exhausted batteries. Rechargeable batteries are only to be charged under adult supervision. Rechargeable batteries are to be removed from the item before being charged. Non-rechargeable batteries are not to be recharged. The supply terminals are not to be short-circuited. Always dispose of exhausted batteries properly. Do NOT dispose of batteries in fire, they may leak or explode.

Warning! This item is not a toy. For decoration only. Small parts, choking hazard. This product is intended for use by persons 15 years of age and older. Not intended for use by children ages 14 years and younger.

WARNING
DO NOT TURN ITEM ON UNTIL YOU HAVE COMPLETELY FINISHED ASSEMBLY.
STAY CLEAR OF ITEM WHILE OPERATING.
DO NOT PLACE ITEM ON UNEVEN GROUND.
DO NOT PLACE WEIGHT ON ITEM WHILE IN OPERATION.

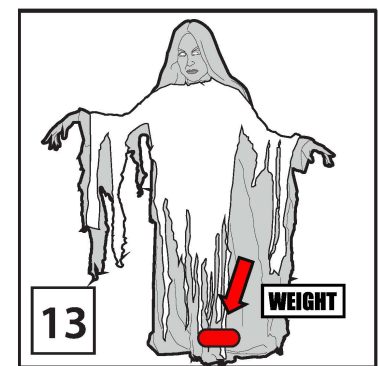

STOP **DO NOT RETURN THIS ITEM TO THE STORE!**
 If experiencing technical difficulties, please go to www.tekkydesign.com for assistance.